



# CONNECTORS MANUFACTURE

## FPC/FFC 0.5mm ZIF SMT TYPE SIDE ENTRY

### SPECIFICATION

Current Rate:0.5 AMP  
 Insulation Resistance:50MΩ Min  
 Contact Resistance:20mΩ Max  
 Dielectric voltage:250V AC for one minute  
 Operation Temperature:-20°C to + 85°C

### MATERIAL

Insulator:Polyester,UL 94V-0  
 ◎ Standard:Nylon 46  
 Contact Pin:Phospor Bronze  
 Finish:Tin Plated

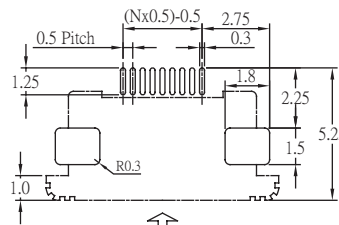
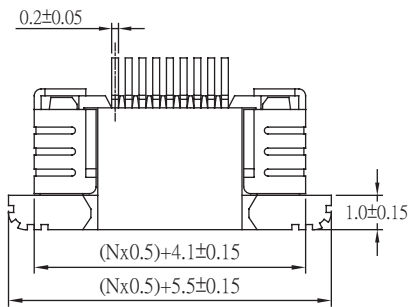

Recommended PCB Layout  
 (PCB TOLERANCE ±0.05)

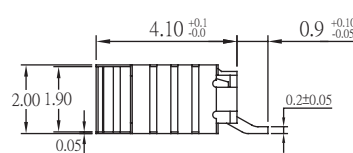
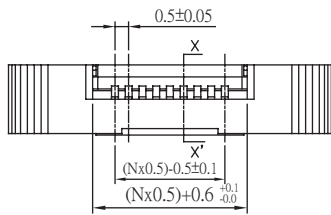

UPPER CONTACT TYPE

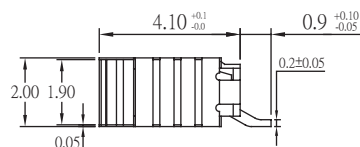
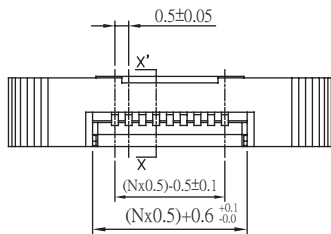
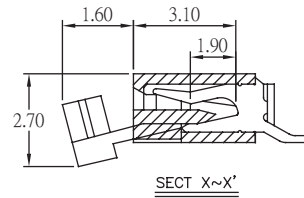

BOTTOM CONTACT TYPE

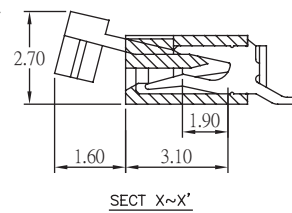

## ORDER INFORMATION

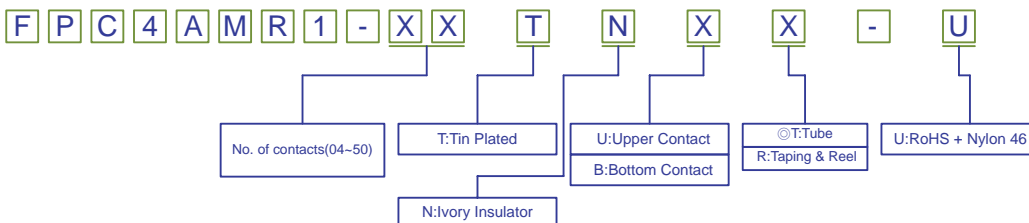

©:Standard Recommend

AMTEK CONNECTORS MANUFACTURE

FPC/FFC CONN.

